

KEY	
	FOOTWAY WORKS
	CARRIAGEWAY WORKS
	CONTROLLED CROSSING – RED TACTILES
	UNCONTROLLED CROSSING – BUFF TACTILES
	BLOCK PAVING
	LANDSCAPE / GRASSED AREA
	PROPOSED BOUNDARY OR RETAINING WALL
	CYCLE LANE WITH RED SURFACING
	BUS LANE WITH RED SURFACING
	GREY HIGH FRICTION SURFACING
	ISLAND REFERENCE

O.S. SHEET REF. VARIOUS
 This map is based upon Ordnance Survey material with the permission of Ordnance Survey on behalf of the Controller of Her Majesty's Stationery Office © Crown Copyright. Unauthorised reproduction infringes Crown copyright and may lead to prosecution or civil proceedings. Leeds City Council 100019567 (2009)

A65 KIRKSTALL ROAD QUALITY BUS INITIATIVE GENERAL ARRANGEMENT (SHEET 1 OF 6)

This drawing is the property of Leeds City Council. It must only be used for the purpose for which it was originally supplied. It must not be copied, published or transmitted by any means to any third party, without the express permission of the originator. Modification or manipulation of all or part of this drawing is strictly forbidden, unless specifically requested or approved by the originator.

AMENDMENTS		DRAWN	CHECK	DATE	DRAWN BY	SCALE
FIRST APPROVED		ALS	SH	03/09	ALS/MW	1:500
a. Layout altered to avoid 132KV cables and to comply with CPU decision		ALS		06/09	ALS/MM	
b. Layout revised using MX.		ALS		09/09		

INITIALS	DATE
ALS/MM	09/09
AutoCAD BY	
ALS/MM	09/09
CHECKED BY	
ALS/MM	09/09

INITIALS	DATE
ALS/MM	09/09



DRAWING NUMBER:
 HDC/713184/100/01b
 DATE: September 2009

FINAL DRAFT

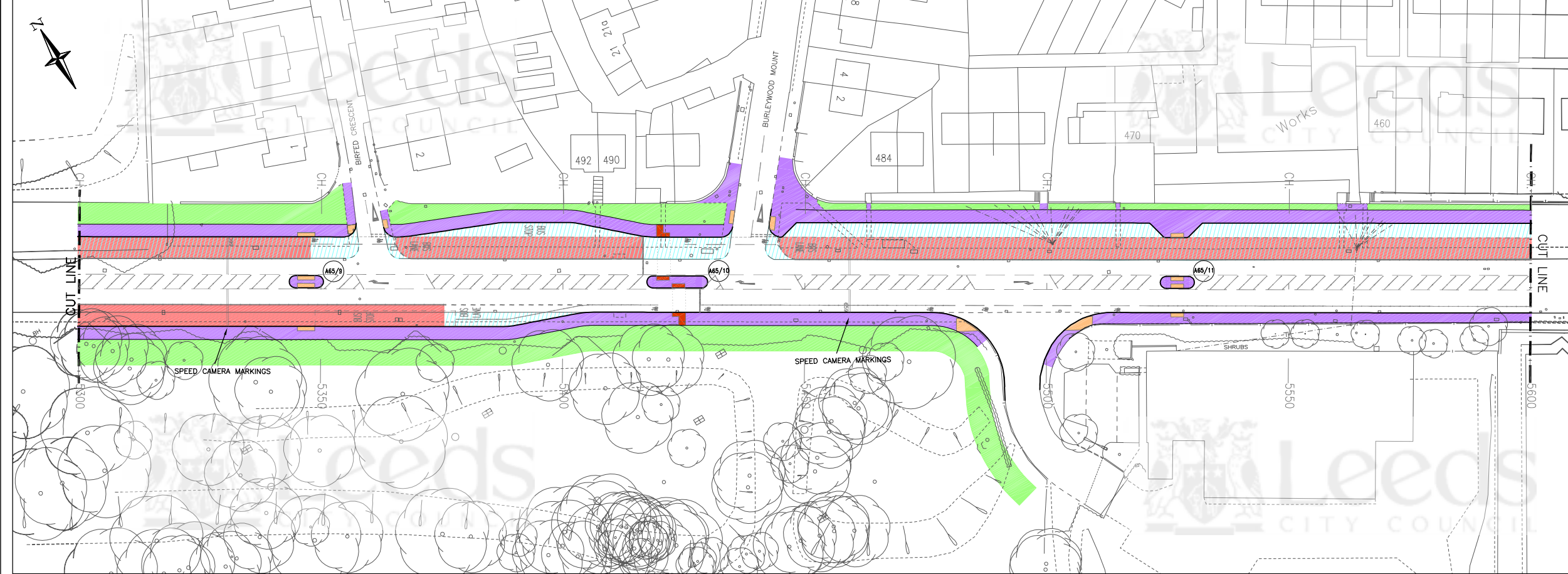

KEY

- FOOTWAY WORKS
- CARRIAGEWAY WORKS
- CONTROLLED CROSSING – RED TACTILES
- UNCONTROLLED CROSSING – BUFF TACTILES
- BLOCK PAVING
- LANDSCAPE / GRASSED AREA
- PROPOSED BOUNDARY OR RETAINING WALL
- CYCLE LANE WITH RED SURFACING
- BUS LANE WITH RED SURFACING
- GREY HIGH FRICTION SURFACING
- X ISLAND REFERENCE

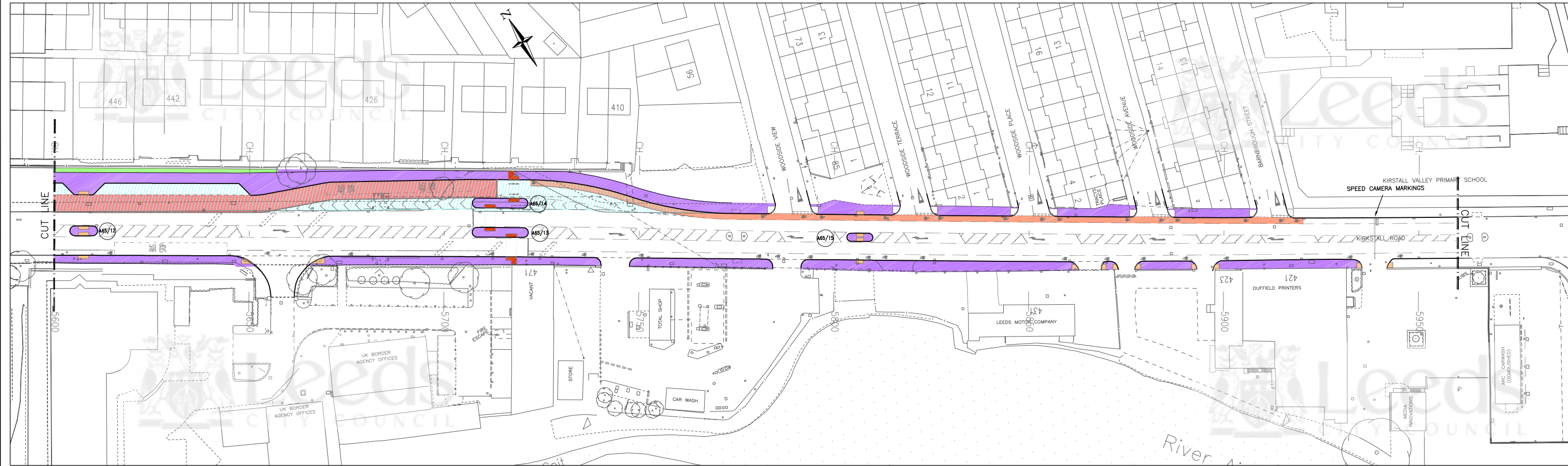

O.S. SHEET REF. VARIOUS
 This map is based upon Ordnance Survey material with the permission of Ordnance Survey on behalf of the Controller of Her Majesty's Stationary Office © Crown Copyright. Unauthorised reproduction infringes Crown copyright and may lead to prosecution or civil proceedings. Leeds City Council 100019567 (2009)

A65 KIRKSTALL ROAD QUALITY BUS INITIATIVE GENERAL ARRANGEMENT (SHEET 2 OF 6)

This drawing is the property of Leeds City Council. It must only be used for the purpose for which it was originally supplied. It must not be copied, published or transmitted by any means to any third party, without the express permission of the originator. Modification or manipulation of all or part of this drawing is strictly forbidden, unless specifically requested or approved by the originator.

AMENDMENTS		DRAWN	CHECK	DATE	DRAWN BY		SCALE	
FIRST APPROVED		ALS	SH	03/09	INITIALS	DATE	1:500	
a. Layout altered to avoid 132KV cables and to comply with CPU decision		ALS		06/09	ALS/MW	09/09	ORIGINAL SHEET SIZE	
b. Layout revised using MX.		ALS		09/09	AutoCAD BY		A1	
					INITIALS	DATE		
					ALS/MM	09/09		
					CHECKED BY			
					INITIALS	DATE		

FINAL DRAFT



DRAWING NUMBER:
HDC/713184/100/02b
 DATE: September 2009

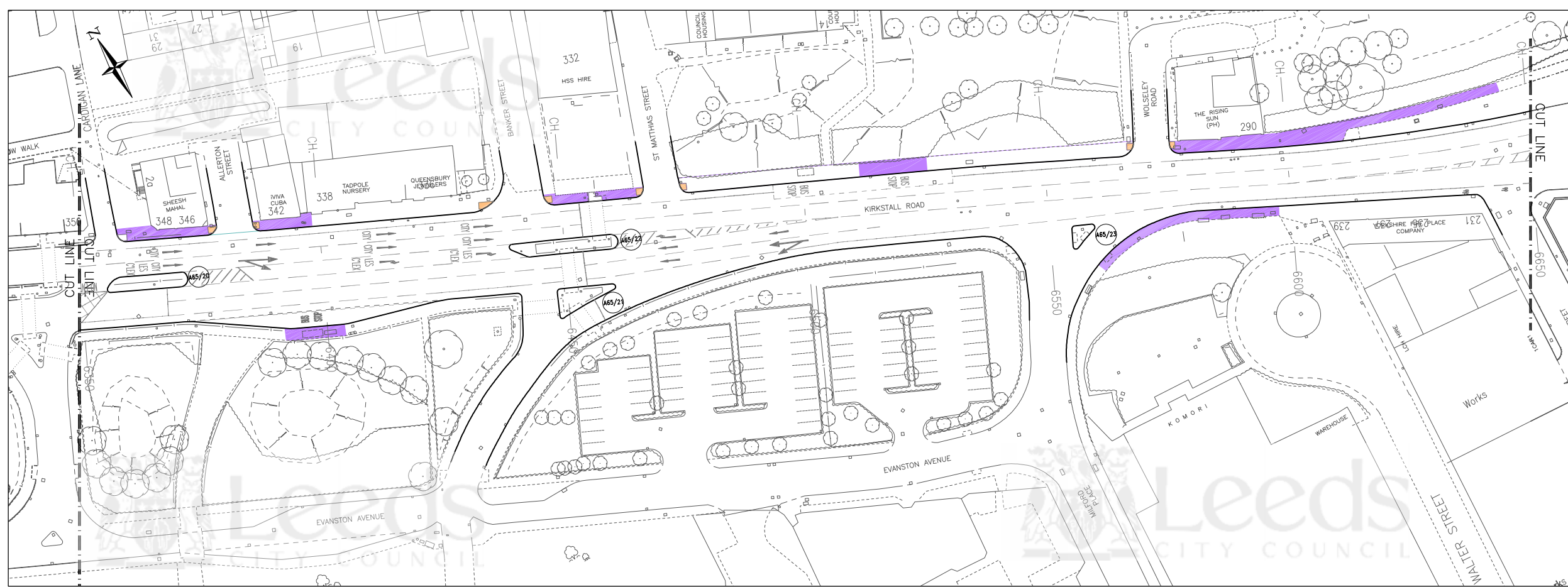
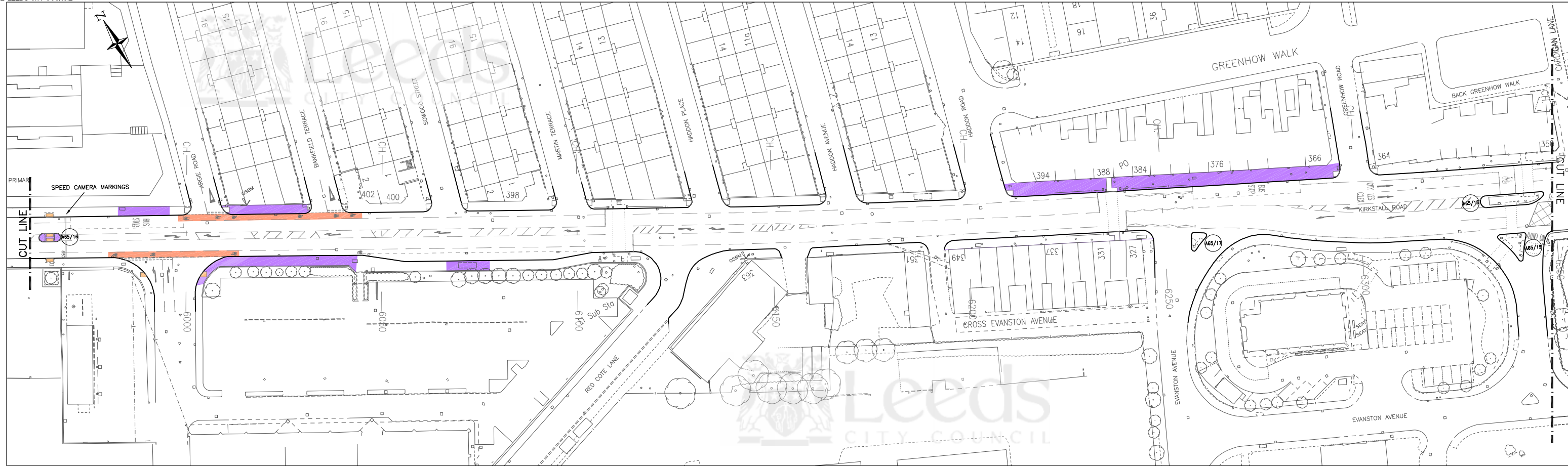

- KEY**
- FOOTWAY WORKS
 - CARRIAGEWAY WORKS
 - CONTROLLED CROSSING – RED TACTILES
 - UNCONTROLLED CROSSING – BUFF TACTILES
 - BLOCK PAVING
 - LANDSCAPE / GRASSED AREA
 - PROPOSED BOUNDARY OR RETAINING WALL
 - CYCLE LANE WITH RED SURFACING
 - BUS LANE WITH RED SURFACING
 - GREY HIGH FRICTION SURFACING
 - X ISLAND REFERENCE

O.S. SHEET REF. VARIOUS
 This map is based upon Ordnance Survey material with the permission of Ordnance Survey on behalf of the Controller of Her Majesty's Stationary Office © Crown Copyright. Unauthorised reproduction infringes Crown copyright and may lead to prosecution or civil proceedings. Leeds City Council 100019567 (2009)

A65 KIRKSTALL ROAD QUALITY BUS INITIATIVE GENERAL ARRANGEMENT (SHEET 3 OF 6)

This drawing is the property of Leeds City Council. It must only be used for the purpose for which it was originally supplied. It must not be copied, published or transmitted by any means to any third party, without the express permission of the originator. Modification or manipulation of all or part of this drawing is strictly forbidden, unless specifically requested or approved by the originator.

AMENDMENTS		DRAWN	CHECK	DATE	DRAWN BY		SCALE
FIRST APPROVED	ALS	SH	SH	03/09	INITIALS	DATE	
a. Footway works updated	ALS			09/09	ALS/MW	09/09	1:500
					AutoCAD BY		
					INITIALS	DATE	
					ALS/MM	09/09	
					CHECKED BY		
					INITIALS	DATE	
							ORIGINAL SHEET SIZE
							A1

FINAL DRAFT



DRAWING NUMBER:
 HDC/713184/100/03a
 DATE: September 2009



KEY

- FOOTWAY WORKS
- CARRIAGEWAY WORKS
- CONTROLLED CROSSING – RED TACTILES
- UNCONTROLLED CROSSING – BUFF TACTILES
- BLOCK PAVING
- LANDSCAPE / GRASSED AREA
- PROPOSED BOUNDARY OR RETAINING WALL
- CYCLE LANE WITH RED SURFACING
- BUS LANE WITH RED SURFACING
- GREY HIGH FRICTION SURFACING
- X ISLAND REFERENCE

O.S. SHEET REF. VARIOUS
 This map is based upon Ordnance Survey material with the permission of Ordnance Survey on behalf of the Controller of Her Majesty's Stationary Office © Crown Copyright. Unauthorised reproduction infringes Crown copyright and may lead to prosecution or civil proceedings. Leeds City Council 100019567 (2009)

A65 KIRKSTALL ROAD QUALITY BUS INITIATIVE GENERAL ARRANGEMENT (SHEET 4 OF 6)

This drawing is the property of Leeds City Council. It must only be used for the purpose for which it was originally supplied. It must not be copied, published or transmitted by any means to any third party, without the express permission of the originator. Modification or manipulation of all or part of this drawing is strictly forbidden, unless specifically requested or approved by the originator.

AMENDMENTS			DRAWN	CHECK	DATE	DRAWN BY		SCALE	
FIRST APPROVED			ALS	SH	03/09	INITIALS	DATE		
a. New PR Base added.			ALS		06/09	ALS/MW	07/09		
b. New MX layout added from Willow Road to West Street Car Park			ALS		09/09				
						AutoCAD BY			
						INITIALS	DATE		
						ALS/MM	07/09		
						CHECKED BY			
						INITIALS	DATE		

FINAL DRAFT

ORIGINAL SHEET SIZE	A1
---------------------	----



DRAWING NUMBER:	HDC/713184/100/04b
DATE:	September 2009



- KEY**
- FOOTWAY WORKS
 - CARRIAGEWAY WORKS
 - CONTROLLED CROSSING – RED TACTILES
 - UNCONTROLLED CROSSING – BUFF TACTILES
 - BLOCK PAVING
 - LANDSCAPE / GRASSED AREA
 - PROPOSED BOUNDARY OR RETAINING WALL
 - CYCLE LANE WITH RED SURFACING
 - BUS LANE WITH RED SURFACING
 - GREY HIGH FRICTION SURFACING
 - X ISLAND REFERENCE



O.S. SHEET REF. VARIOUS
 This map is based upon Ordnance Survey material with the permission of Ordnance Survey on behalf of the Controller of Her Majesty's Stationery Office © Crown Copyright. Unauthorised reproduction infringes Crown copyright and may lead to prosecution or civil proceedings. Leeds City Council 100019567 (2009)

A65 KIRKSTALL ROAD QUALITY BUS INITIATIVE GENERAL ARRANGEMENT (SHEET 5 OF 6)

This drawing is the property of Leeds City Council. It must only be used for the purpose for which it was originally supplied. It must not be copied, published or transmitted by any means to any third party, without the express permission of the originator. Modification or manipulation of all or part of this drawing is strictly forbidden, unless specifically requested or approved by the originator.

AMENDMENTS			DRAWN	CHECK	DATE	DRAWN BY		SCALE	
FIRST APPROVED			ALS	SH	03/09	INITIALS	DATE	1:500	
a. Layout altered to remove proposed lay-by outside Benfield Ford Garage			ALS		06/09	ALS/MW	09/09	ORIGINAL SHEET SIZE	
b. New MX layout added from Willow Road to West Street Car Park			ALS		09/09	AutoCAD BY		A1	
						INITIALS	DATE		
						CHECKED BY			
						INITIALS	DATE		

FINAL DRAFT



DRAWING NUMBER:
HDC/713184/100/05b
 DATE: **September 2009**

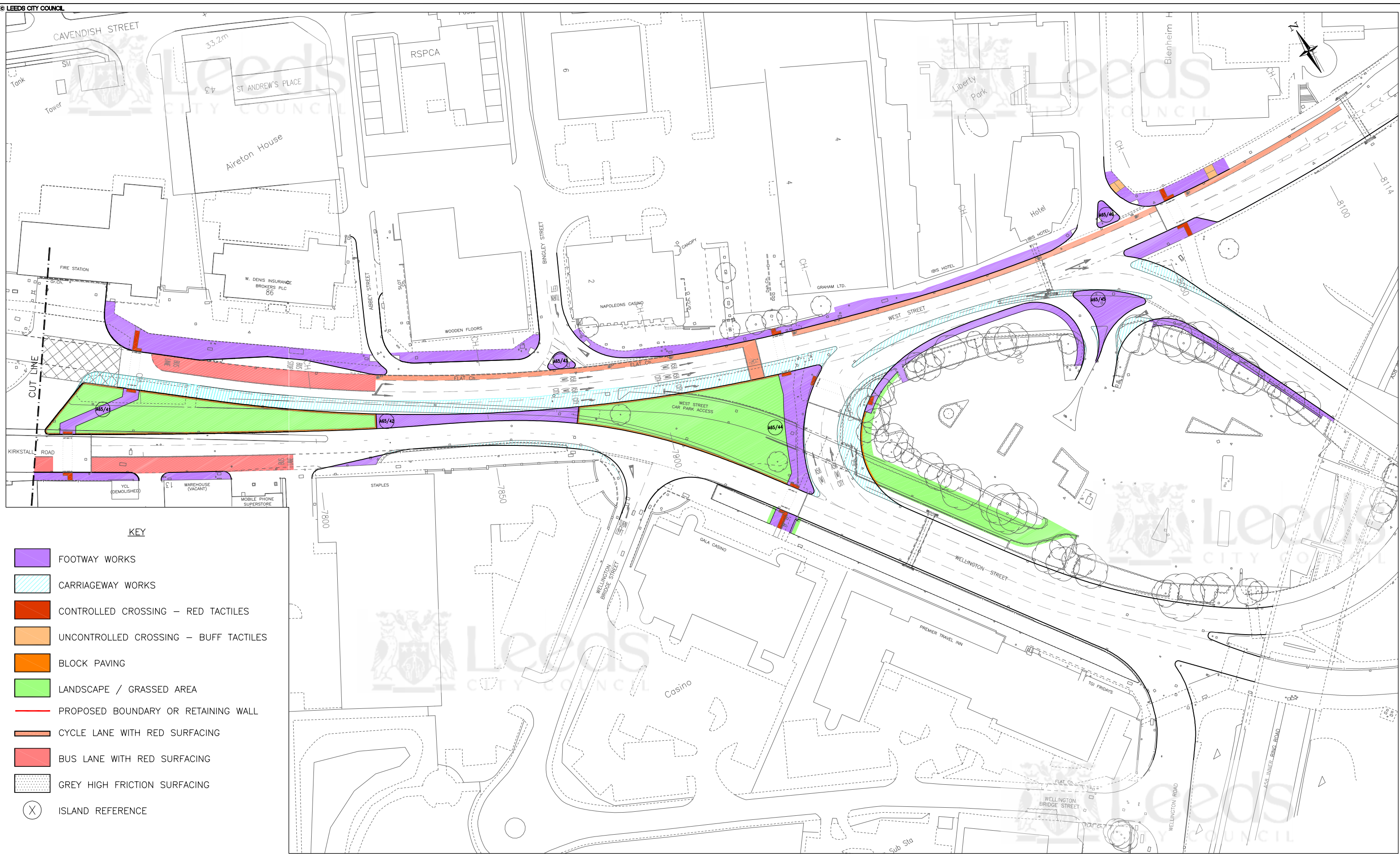

- KEY**
- FOOTWAY WORKS
 - CARRIAGEWAY WORKS
 - CONTROLLED CROSSING – RED TACTILES
 - UNCONTROLLED CROSSING – BUFF TACTILES
 - BLOCK PAVING
 - LANDSCAPE / GRASSED AREA
 - PROPOSED BOUNDARY OR RETAINING WALL
 - CYCLE LANE WITH RED SURFACING
 - BUS LANE WITH RED SURFACING
 - GREY HIGH FRICTION SURFACING
 - X ISLAND REFERENCE

O.S. SHEET REF. VARIOUS
 This map is based upon Ordnance Survey material with the permission of Ordnance Survey on behalf of the Controller of Her Majesty's Stationery Office © Crown Copyright. Unauthorised reproduction infringes Crown copyright and may lead to prosecution or civil proceedings. Leeds City Council 100019567 (2009)

A65 KIRKSTALL ROAD QUALITY BUS INITIATIVE GENERAL ARRANGEMENT (SHEET 6 OF 6)

This drawing is the property of Leeds City Council. It must only be used for the purpose for which it was originally supplied. It must not be copied, published or transmitted by any means to any third party, without the express permission of the originator. Modification or manipulation of all or part of this drawing is strictly forbidden, unless specifically requested or approved by the originator.

AMENDMENTS		DRAWN	CHECK	DATE	DRAWN BY		SCALE
FIRST APPROVED	ALS	SH	03/09	INITIALS	DATE		
a. Layout altered to accommodate UTC changes at West Street Car Park	ALS		06/09	ALS/MW	09/09		1:500
b. New MK layout added from Willow Road to West Street Car Park	ALS		09/09	AutoCAD			
Wellington Bridge St. junction amended.	ALS		09/09	ALS/MM	09/09		
CHECKED BY							
INITIALS	DATE						

FINAL DRAFT

ORIGINAL SHEET SIZE	A1
---------------------	----



DRAWING NUMBER:
 HDC/713184/100/06b
 DATE: September 2009